

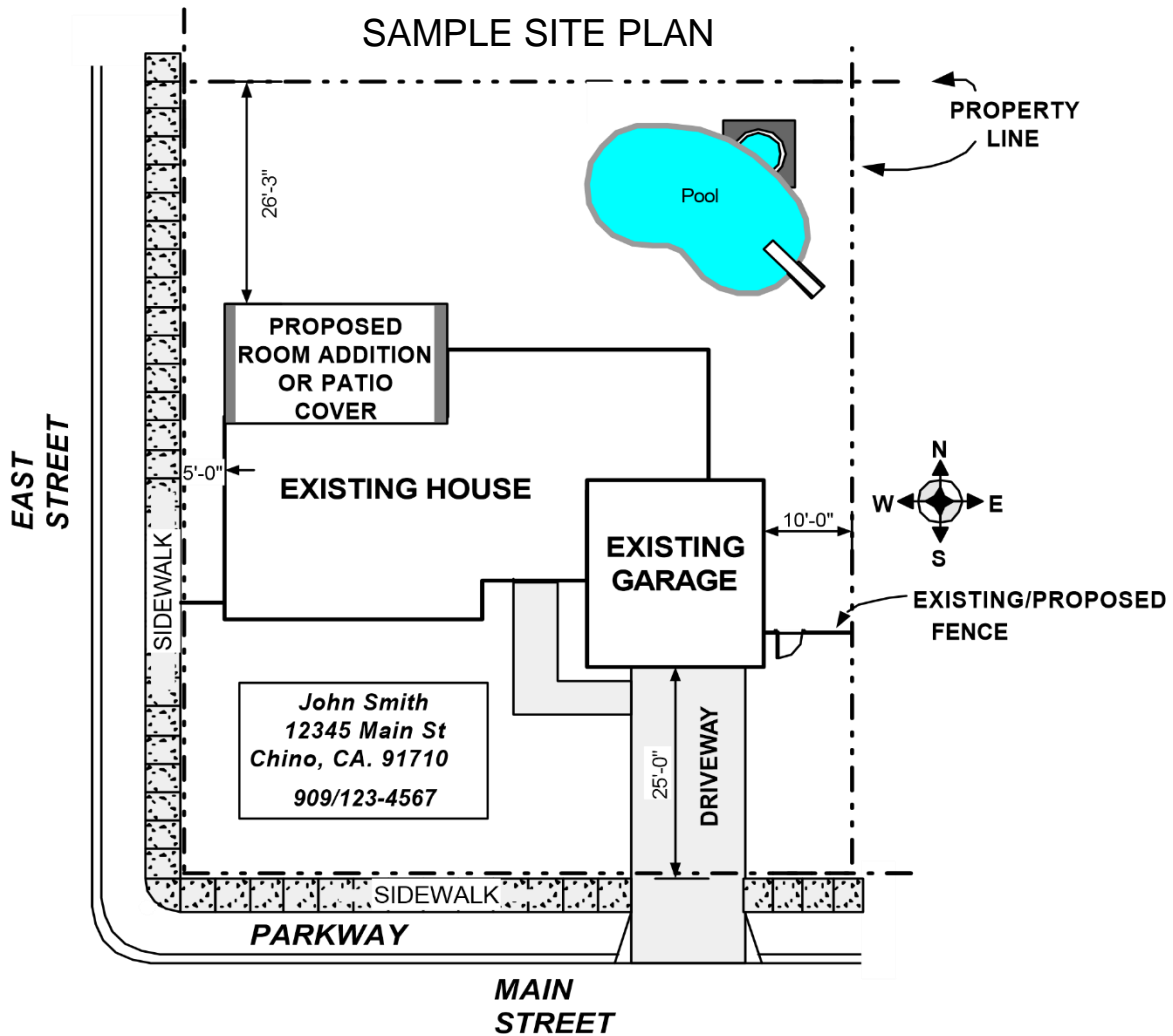

City of Chino
Community Development Department
13220 Central Avenue
Chino, CA 91710
Phone: (909) 334-3251
Fax: (909) 334-3729



Provide and observe the following:

1. Provide two (2) sets of plans (minimum) are required for all building permits.
2. Plans are to be drawn neatly and must be legible (no graph paper).
3. Minimum 8 1/2" x 11" sheet size. (Fill sheet with site plan. Do not use edge of paper for property lines.)
4. Provide project address, owner's name, and phone number.
5. Show all streets, driveways, and alleys (if any).
6. Clearly show all proposed and existing construction with complete dimensions.
7. Indicate the owners name, address, and phone number.
8. Indicate all easement locations (refer to your title report for this information).
9. Show north arrow.

Note: All dimensions shown on this sample plan are for reference only. Your site plan must show the actual dimensions for the lot located at the address.